

UNITED STATES
DEPARTMENT OF THE INTERIOR
GEOLOGICAL SURVEY

STATE OF KANSAS

PENCE NW QUADRANGLE
KANSAS
7.5 MINUTE SERIES (TOPOGRAPHIC)
NW/4 PENCE 15' QUADRANGLE

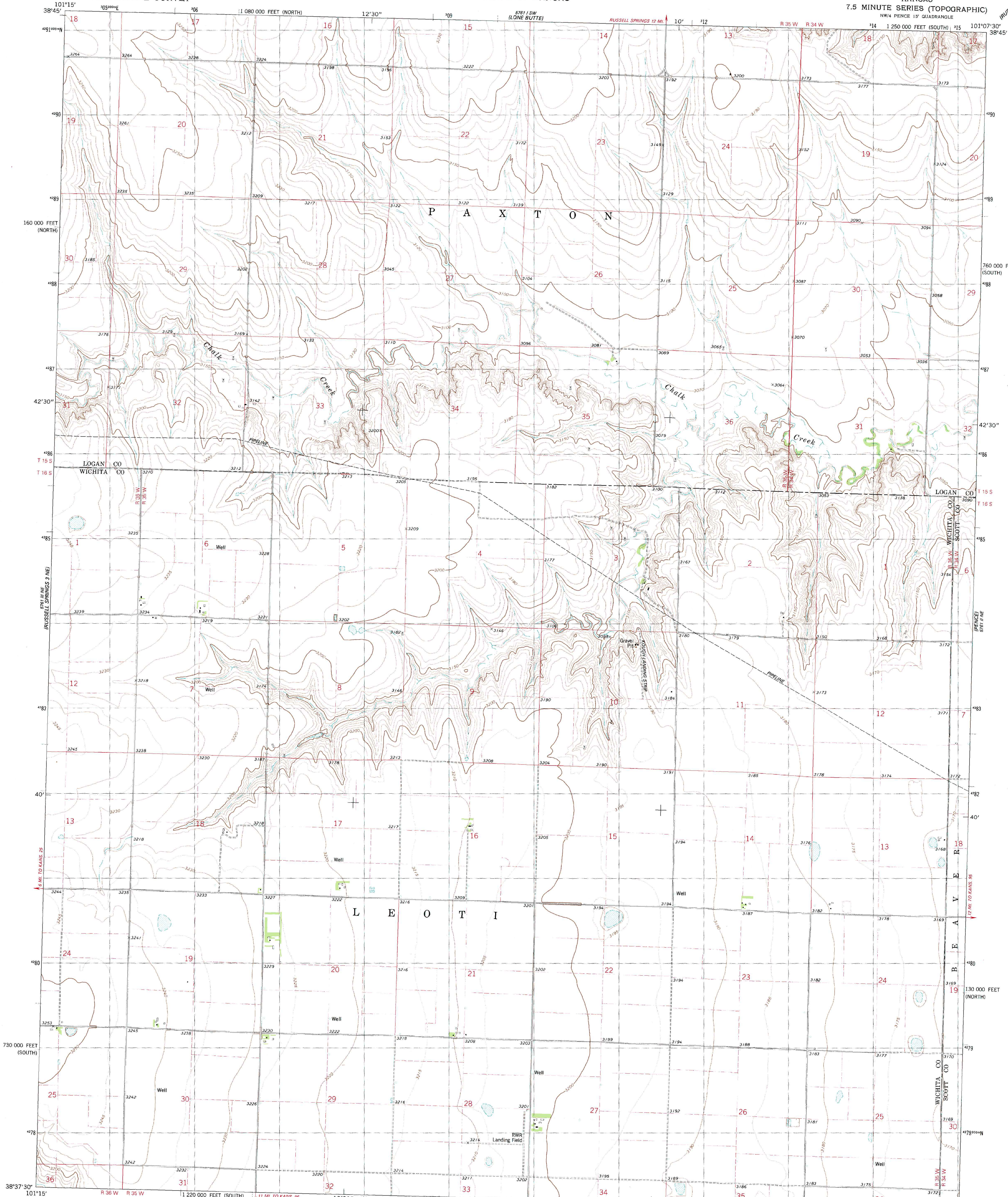

Mapped, edited, and published by the Geological Survey
in cooperation with State of Kansas agencies

Control by USGS and NOS/NOAA

Topography by photogrammetric methods from aerial
photographs taken 1974. Field checked 1976

Projection: Kansas coordinate system, south zone
(Lambert conformal conic)

10,000-foot grid ticks based on Kansas coordinate
system, south and north zones

1000-meter Universal Transverse Mercator grid, zone 14
1927 North American datum

Fine red dashed lines indicate selected fence and field lines where
generally visible on aerial photographs. This information is unchecked

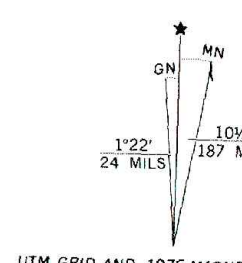

SCALE 1:24 000
0 1000 2000 3000 4000 5000 6000 7000 FEET
0 1 2 3 4 5 6 7 KILOMETER
CONTOUR INTERVAL 10 FEET
DOTTED LINES REPRESENT 5-FOOT CONTOURS
NATIONAL GEODETIC VERTICAL DATUM OF 1929

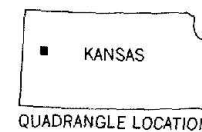

ROAD CLASSIFICATION
Primary highway, hard surface
Secondary highway, hard surface
Unimproved road
Light duty road, hard or improved surface
Interstate Route
U. S. Route
State Route

PENCE NW, KANS.
NW/4 PENCE 15' QUADRANGLE
N3837.5 - W10107.5/7.5

1976

AMS 5761 II NW-SERIES V878