

6460 11 SE
CONWAY

UNITED STATES
DEPARTMENT OF THE INTERIOR
GEOLOGICAL SURVEY

HALSTEAD NW QUADRANGLE
KANSAS
7.5 MINUTE SERIES (TOPOGRAPHIC)

6460 5E
MC PHERSON SE

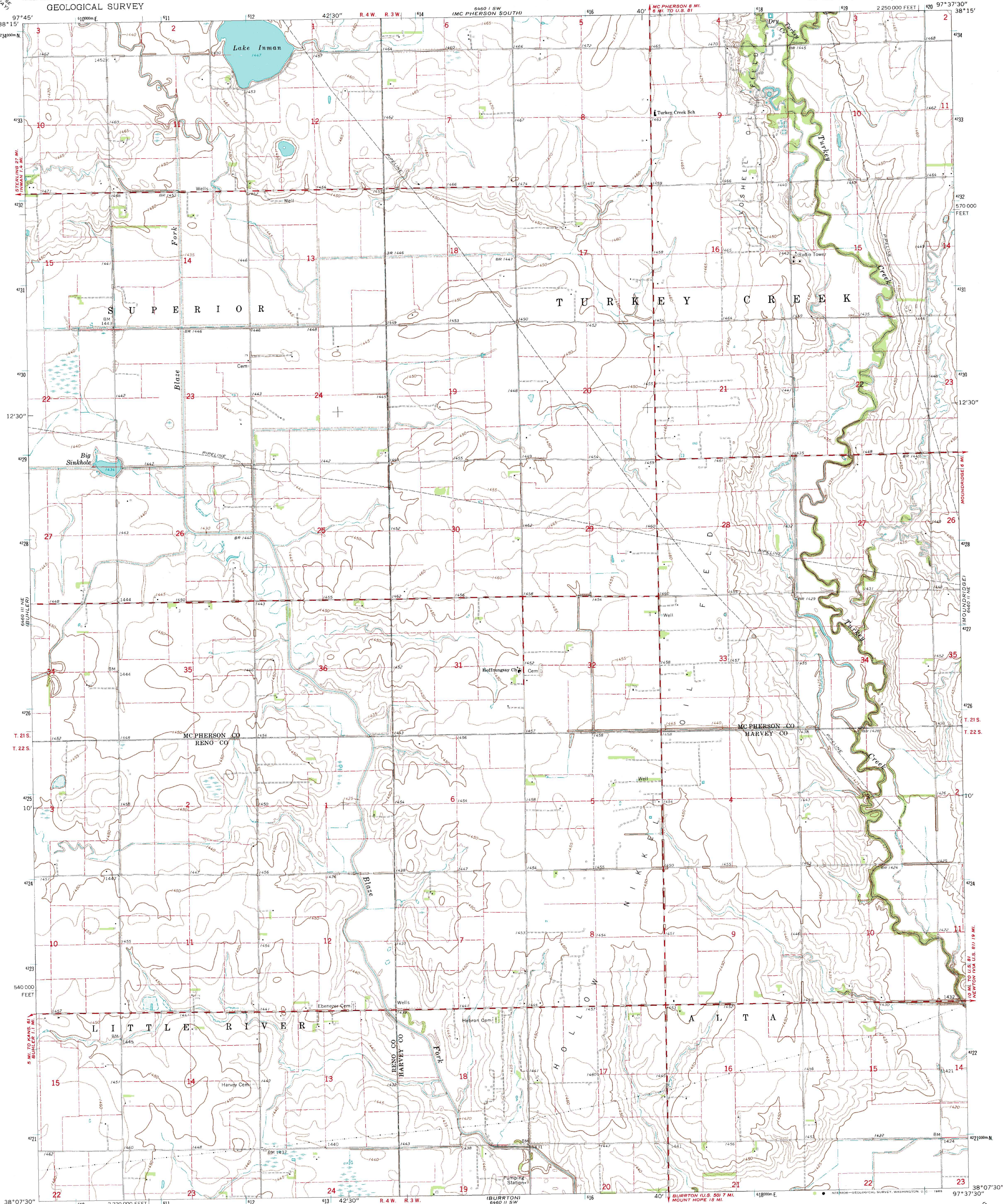

6460 11 SE
BUHLER 11 SE

Mapped, edited, and published by the Geological Survey
Control by USGS and USC&GS
Topography by photogrammetric methods from aerial
photographs taken 1962. Field checked 1965
Polyconic projection. 1927 North American datum
10,000-foot grid based on Kansas coordinate system, south zone
1000-meter Universal Transverse Mercator grid ticks,
zone 14, shown in blue
Fine red dashed lines indicate selected fence and field lines where
generally visible on aerial photographs. This information is unchecked

UTM GRID AND 1965 MAGNETIC NORTH
DECLINATION AT CENTER OF SHEET
MAGNETIC NORTH
1965
15 MILS

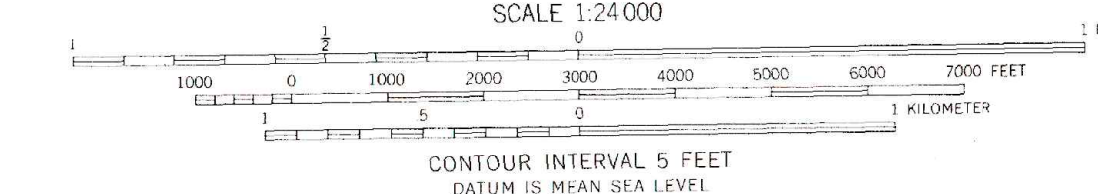

THIS MAP COMPLIES WITH NATIONAL MAP ACCURACY STANDARDS
FOR SALE BY U.S. GEOLOGICAL SURVEY, DENVER, COLORADO 80225 OR WASHINGTON, D. C. 20242
AND BY THE STATE GEOLOGICAL SURVEY, LAWRENCE, KANSAS
A FOLDER DESCRIBING TOPOGRAPHIC MAPS AND SYMBOLS IS AVAILABLE ON REQUEST

ROAD CLASSIFICATION
Medium-duty ——— Light-duty ———
Unimproved dirt ———

HALSTEAD NW, KANS.
N3807.5—W9737.5/7.5

1965

AMS 6460 11 NW—SERIES V878

6460 11 SE
HALSTEAD 11 SE