

UNITED STATES
DEPARTMENT OF THE INTERIOR
GEOLOGICAL SURVEY

STATE OF KANSAS

JOHNSON EAST QUADRANGLE
KANSAS-STANTON CO.
7.5 MINUTE SERIES (TOPOGRAPHIC)

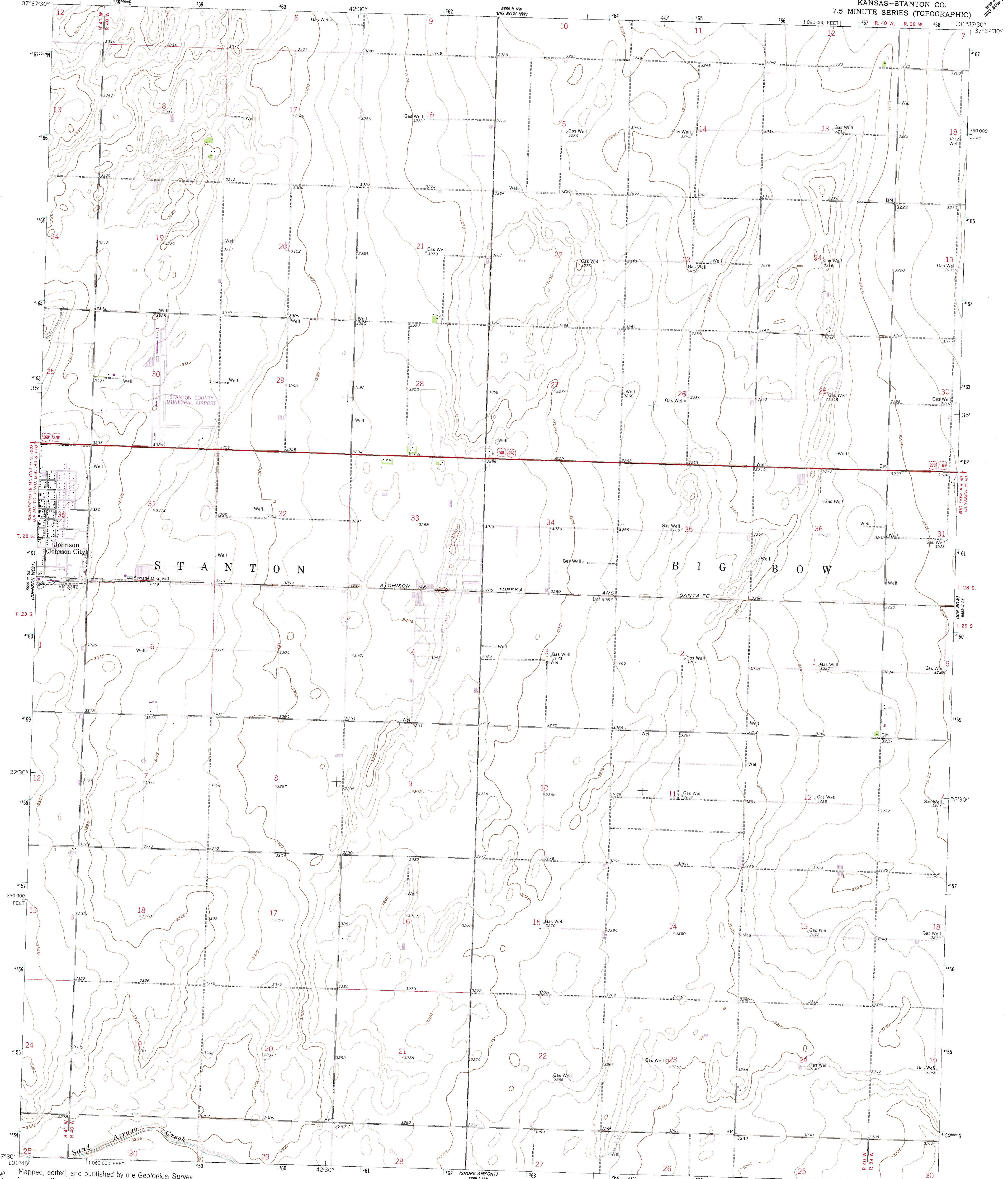

Maped, edited, and published by the Geological Survey
in cooperation with State of Kansas agencies
Control by USGS and USC&GS

Culture and drainage in part compiled from aerial photographs
taken 1958. Topography by planetable surveys 1959
Polyconic projection. 1927 North American datum
10,000-foot grid based on Kansas coordinate system, south zone
1000-meter Universal Transverse Mercator grid ticks,
zone 14, shown in blue

Revisions shown in purple compiled from aerial photographs taken
1977. Map edited 1978. This information not field checked

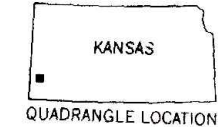
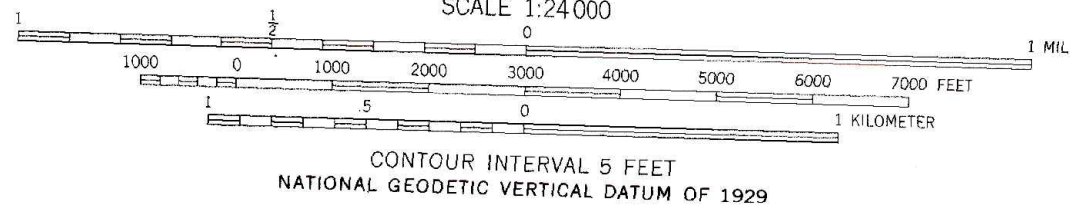
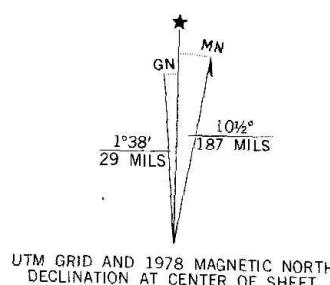

ROAD CLASSIFICATION
Heavy-duty ——— Light-duty ———
Unimproved dirt ———
U.S. Route

THIS MAP COMPLIES WITH NATIONAL MAP ACCURACY STANDARDS
FOR SALE BY U.S. GEOLOGICAL SURVEY, DENVER, COLORADO 80225, OR RESTON, VIRGINIA 22092
AND STATE GEOLOGICAL SURVEY, LAWRENCE, KANSAS 66044
A FOLDER DESCRIBING TOPOGRAPHIC MAPS AND SYMBOLS IS AVAILABLE ON REQUEST

JOHNSON EAST, KANS.
(FORMERLY BIG BOW SW)
N3730-W10137.5/7.5

1959
PHOTOGRAPHED 1978
AMS 5659 II SW-SERIES Y878